



**SMART PLUG**  
SMART MODULE SERIES  
#SwitchToSmart



**DESCRIPTION**

Smart Plug is a compact and retrofit **Wi-Fi Switch** that lets you control (**ON/OFF**) any of your plugged-in appliances from anywhere in your house or outside with just your mobile device.

You can also automate the **ON/OFF** functionality of your appliances based on the trigger of other Smart Devices in your home through Hogar SE App.



CONTROL ANY APPLIANCE



WI FI COMPATIBILITY



EASY INSTALLATION



TIME SCHEDULING



LINKAGE TO OTHER SMART DEVICES



APP CONTROL



VOICE CONTROL

ACTION	WHAT SMART PLUG DOES?
Press & Hold Button for 5 Seconds	Blue led blinks rapidly Enter into enrolling mode.
Short Press button	Manually on/off the device
Smart Plug Switched On	<b>PURPLE</b> led Constantly On
Smart Plug Switched Off	<b>BLUE</b> LED Constantly On

**SPECIFICATIONS**

Model Number	HC-PLG-001
Power Requirement	AC 180-240V, 50Hz.
Nominal Input Voltage	AC 230V
Static Current	<= 10 µA
Body Size	56 x 52 x 30mm
Operating Temperature	-10°C to 40°C
Wireless Range	50m Outdoor - 20m Indoor
Humidity	0-80% RH
Wireless Protocol	IEEE802.11 b/g/n
Encryption Type	WEP/TKIP/AES, WPS

**ADDING SMART PLUG TO YOUR HOME**

- Open the Hogar SE App and go to **"Rooms"**.
- Click on **"+"** Button and select **"Smart Plug"**. Follow the prompts on your App for subsequent operations.
- To **POWER ON**, **press and hold** the button on the Smart Plug for **5 seconds**.
- You will soon see the **BLUE LED** blinking rapidly that indicates that Smart Plug has entered into **"Enrolling Mode"**.
- Input the password of your designated Wi-Fi network on the App to include the Smart Plug to the Cloud.

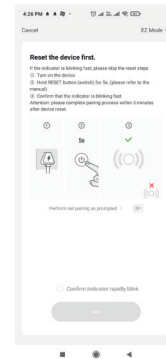

- Your Smart Plug will be added successfully to your Hogar SE App in less than 30 seconds.

**WARRANTY**

Hogar Provides Limited Warranty of 18 months on every product

**ENQUIRY**

For Orders/Details, kindly reach out to us at [info@hogarcontrols.com](mailto:info@hogarcontrols.com)



Scan QR code for more details and Sales enquiries